

Receiver

From

Company name  
Respons. Department  
Person in charge  
Phone number  
Fax no  
E-mail address

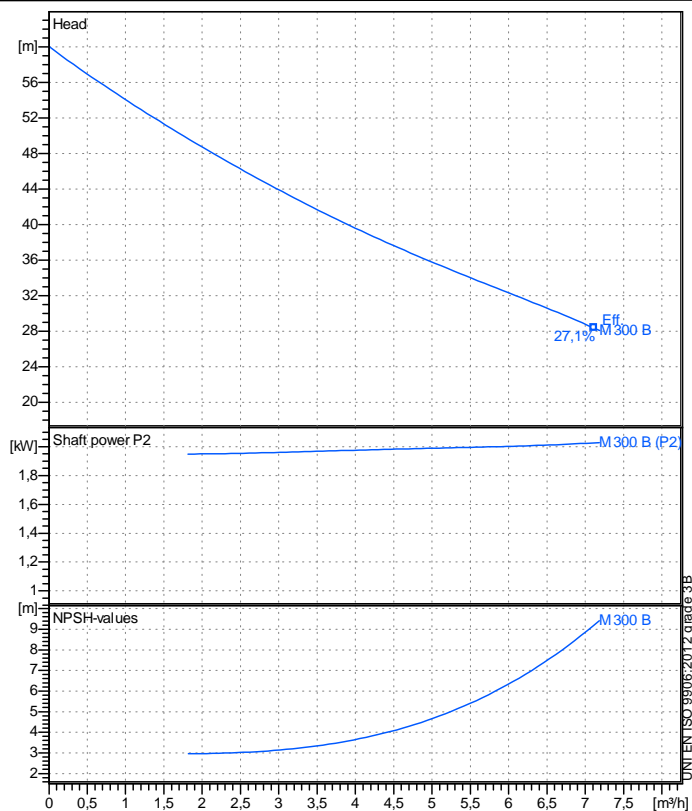

### Operating data specification

Nominal flow	m³/h	0
Nominal head	m	0
Static head	m	0
NPSH - v value of plant	m	0
Inlet pressure	bar	0,09793
Fluid	Water, pure	
Operating temperature t A	°C	20
Density at t A	kg/m³	998,3
Kin. viscosity at t A	mm²/s	1,005

### Pump

Pump name	M 300 B		
Size			
Design			
Speed rpm	2850	No of stages	1
Impeller type			
Flow	Nominal	m³/h	
	Max-	m³/h	7,19
	Min-	m³/h	0
Head	Nominal	m	
	Max-	m	60
	Min-	m	28,1
Head H(Q=0)	m	60	
NPSH 3%	m		
Max. working pressure	bar	5,88	
Shaft power	kW		
Efficiency	%		
Max absorbed power	kW	2,0285	

### Materials Pump

Pump body	Cast iron G20		
Plug	Brass		
Gasket	Aluminium		
Nut	Brass		
Impeller	Brass		
Rotating mechanical seal	Graphite		
Fixed mechanical seal	Ceramic		
OR	Rubber NBR		
Seal retaining disc	Stainless steel AISI 304		
</			

### Dimensions in mm

a	160,5
b	168,5
DNA	G 1 1/2"
DNM	G 1 1/4"
f	246,5
H	235
h1	120
h2	233
n1	180
n2	228
od	11
w	180

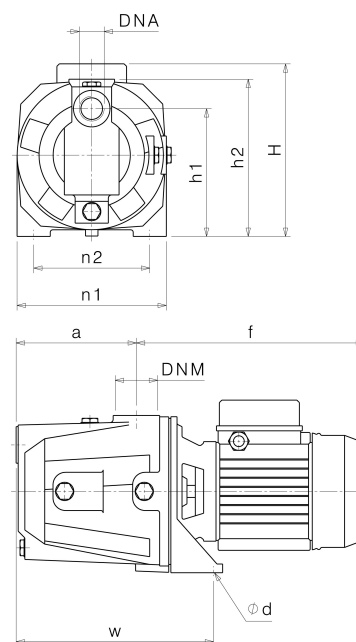

Remarks:

Project	Project ID	Created by	Created on	Last update
			2019-02-13	